

Product Parameters (产品描述)

产品编号 | Part Number: KB-M11-xx-XP
出光角度 | Beam Angle: 15/25/50/15*50°
产品材料 | Material: PC
工作温度 | Work Temp: <90°C

安装方式 | Fastening: Pins/Glue
支架颜色 | /
透光率 | Transmittance: 93%
匹配LED | Match Led: Cree-XP/3535 Leds

Part Number	Lens Surface	Dimension	Beam Angle
KB-M11-15F-XP	镜面/clear	L12.88*W11.06*H7.27mm	~15°
KB-M11-25F-XP	镜面/clear	L12.88*W11.06*H7.27mm	~25°
KB-M11-25PF-XP	珠面/beads	L12.88*W11.06*H7.27mm	~25°
KB-M11-50PF-XP	珠面/beads	L12.88*W11.06*H7.27mm	~50°
KB-M11-1550-XP	条纹面/ellipse	L12.88*W11.06*H7.27mm	~15*50°

Direction for Use

(透镜 | LENS)

- 1, Please use some soft paper or pure water to clean lens (reflector)
- 2, Don't use any industrial solvent to clean lens surface , such as alcohol
- 3, Storage environment : Temperature 0~40°C , Humidity 30%~95%
- 4, This kind of lens can make the lighting more concentrated, and it's made from transparent material , so please do not open the packages until you use them, in case of the dust and other pollutions.

Light Distribution Curve (配光曲线图):

CREE

Part Number: KB-M11-15F-XP

LED: XP-E

Beam Angle: 14.4°

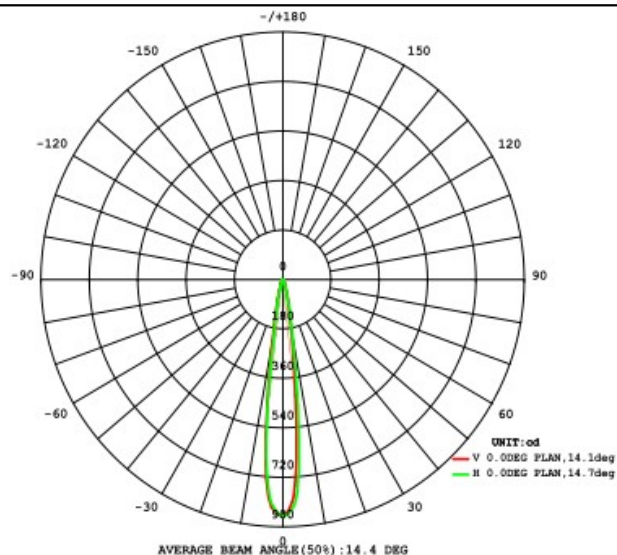

CREE

Part Number: KB-M11-25F-XP

LED: XP-E

Beam Angle: 25.4°

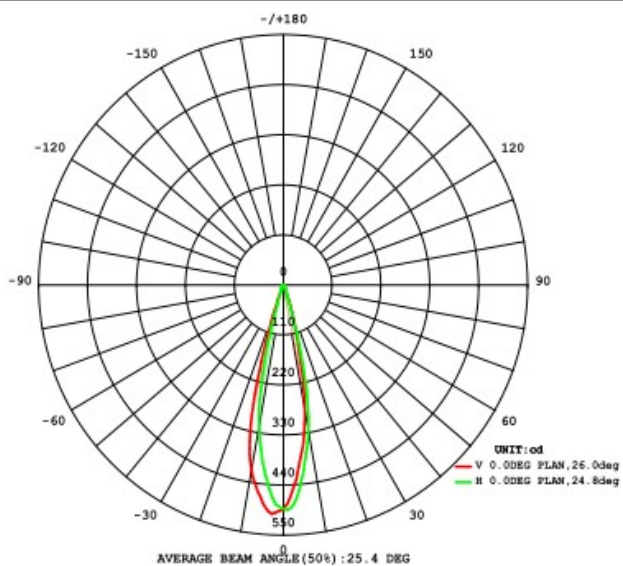

CREE

Part Number: KB-M11-25PF-XP

LED: XP-E

Beam Angle: 25.8°

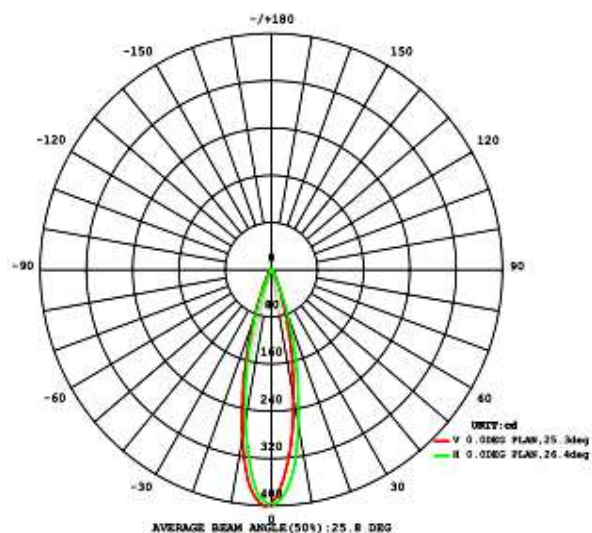

Light Distribution Curve (配光曲线图):

CREE

Part Number: KB-M11-50F-XP

LED: XP-E

Beam Angle: 47.7°

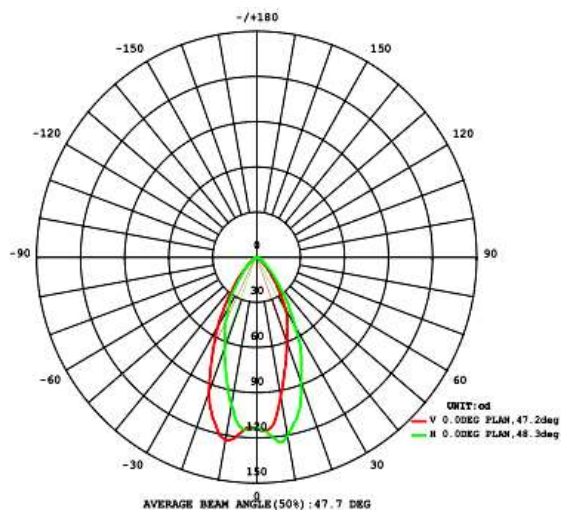

CREE

Part Number: KB-M11-1550F-XP

LED: XP-E

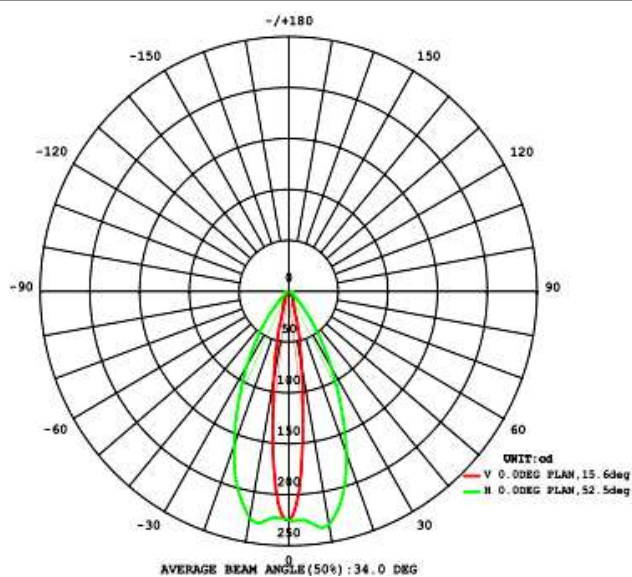

Beam Angle: 15*52°

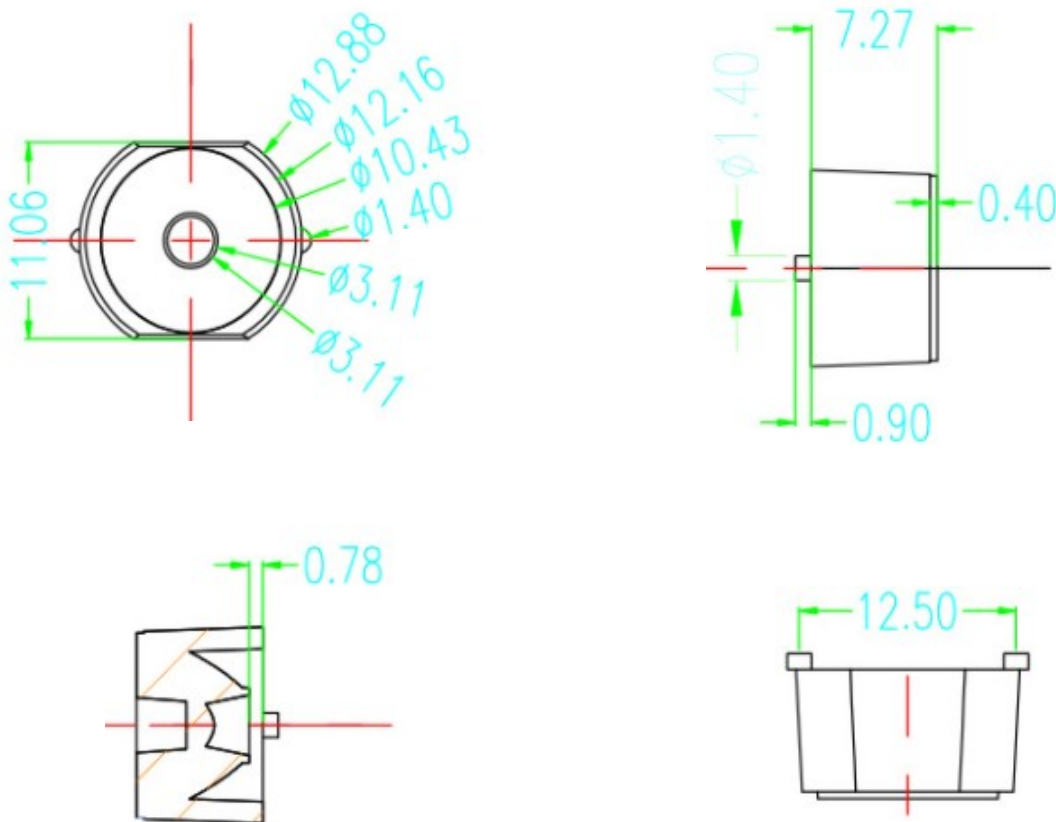

Mechanical Characteristics (产品尺寸):

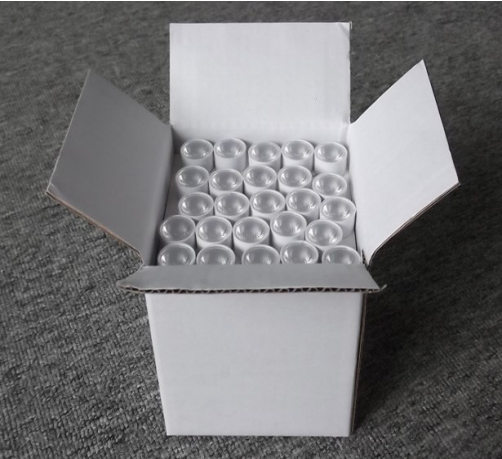

Product Package (产品包装):

Inner Box (内盒)	Outer Carton (外箱)
	
<p>25pcs/layer 9layers/box Gross weight: 0.8kg/box Box dimension: 13*13*13cm</p>	<p>20boxes/carton 4,500pcs/carton Gross weight: 17kg/CTN Carton Dimension: 64*28*32cm</p>