



Product Parameters (产品描述)

产品编号 | Part No.: KB-H22-xxF-RGBW
出光角度 | Angle: 20/25/30/45/60/Oval
产品材料 | Material: PMMA
工作温度 | Work Temp: <85℃

安装方式 | Fastening: Glue/Clips
支架颜色 | Holder Color:
透光率 | Transmittance: 93%
匹配LED | Match Led: SMD5050 RGBW Leds

Part Number	Lens Surface	Dimension	Beam Angle
KB-H22-15PF-RGBW	珠面/beads	Φ22.7*H12.0mm	~20°
KB-H22-20PF-RGBW	珠面/beads	Φ22*H11.6mm	~25°
KB-H22-30PF-RGBW	珠面/beads	Φ22*H11.6mm	~30°
KB-H22-45PF-RGBW	珠面/beads	Φ22*H11.6mm	~45°
KB-H22-60PF-RGBW	珠面/beads	Φ22*H11.6mm	~60°
KB-H22-2030F-RGBW	条纹面/strip	Φ22*H11.6mm	~20*30°
KB-H22-2045F-RGBW	条纹面/strip	Φ22*H11.6mm	~20*45°
KB-H22-1060F-RGBW	条纹面/strip	Φ22*H11.6mm	~25*45°

Direction for Use

(透镜 | LENS)

- 1, Please use some soft paper or pure water to clean lens (reflector)
- 2, Don't use any industrial solvent to clean lens surface , such as alcohol
- 3, Storage environment : Temperature 0~40℃ , Humidity 30%~95%
- 4, This kind of lens can make the lighting more concentrated, and it's made from transparent material , so please do not open the packages until you use them, in case of the dust and other pollutions.

Light Distribution Curve (配光曲线图):

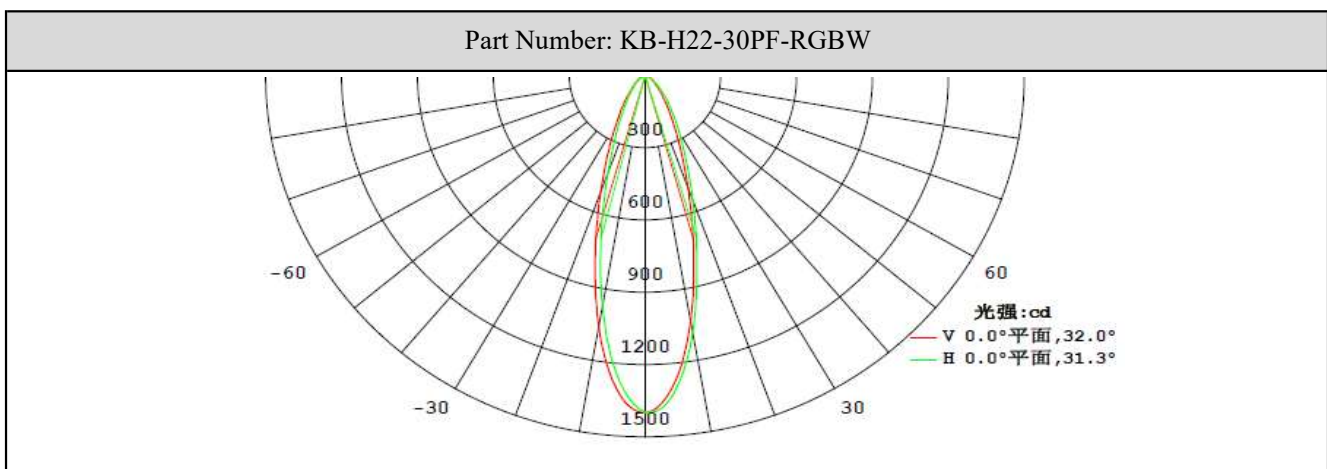
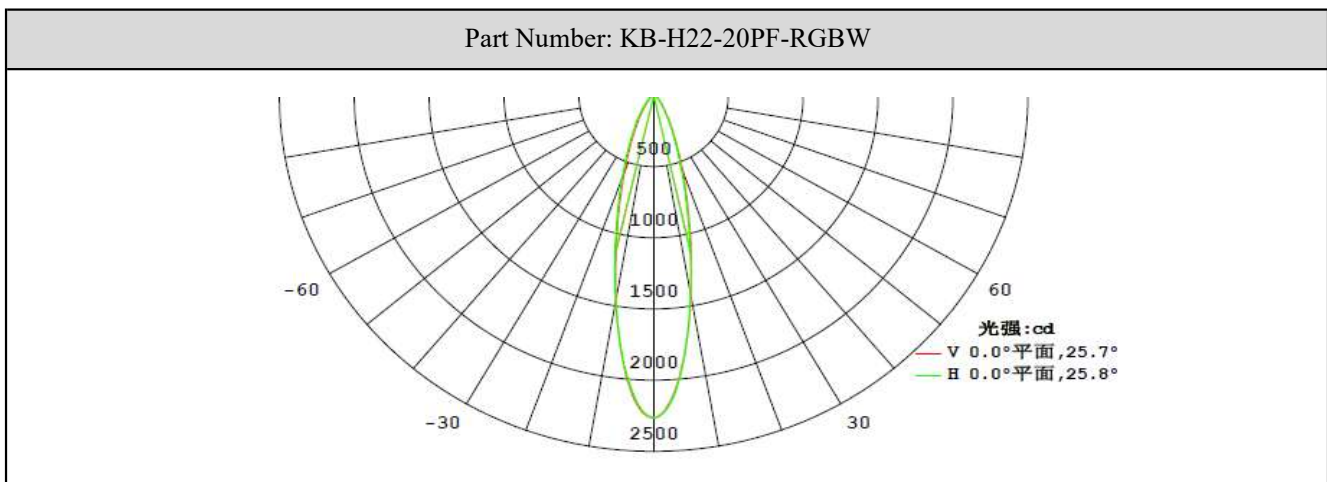
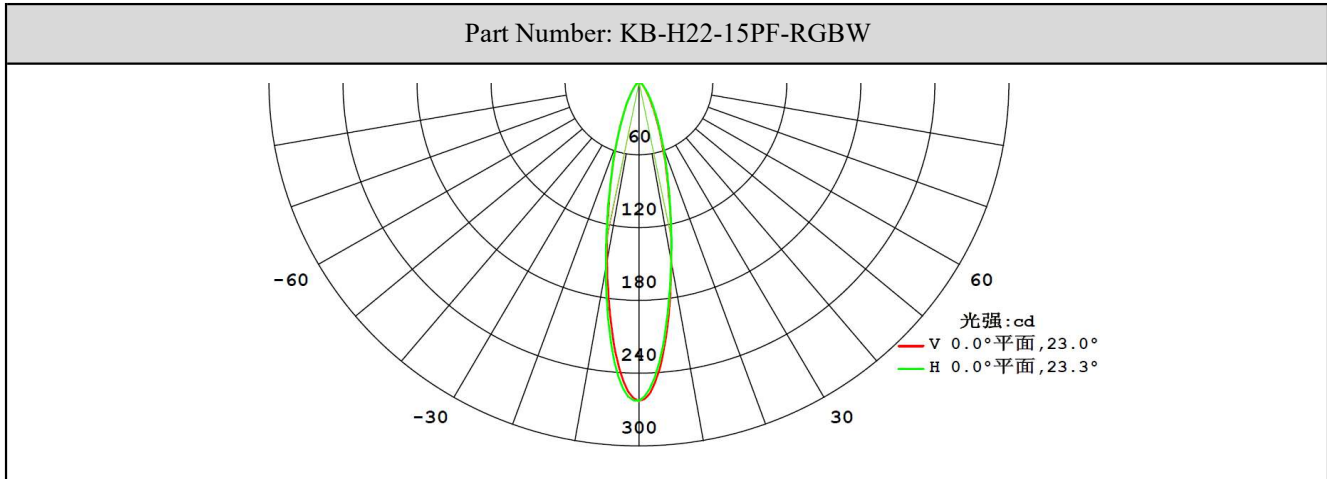

Light Distribution Curve (配光曲线图):

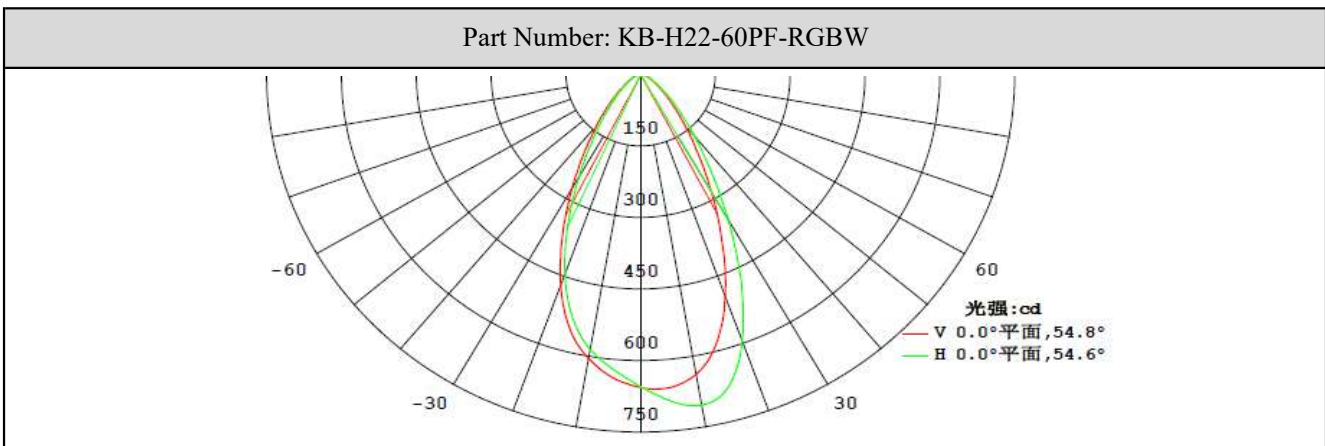
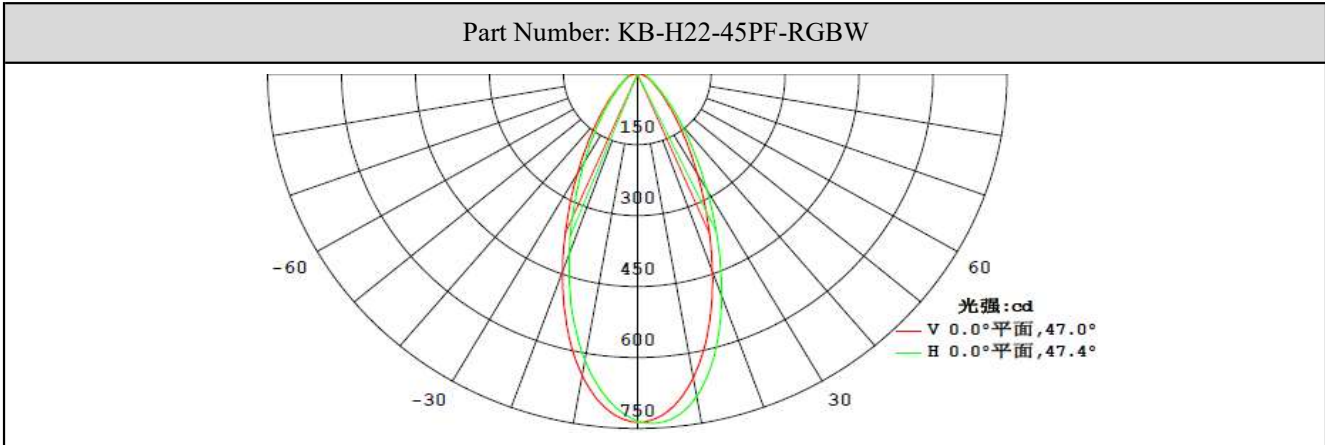

Light Distribution Curve (配光曲线图):

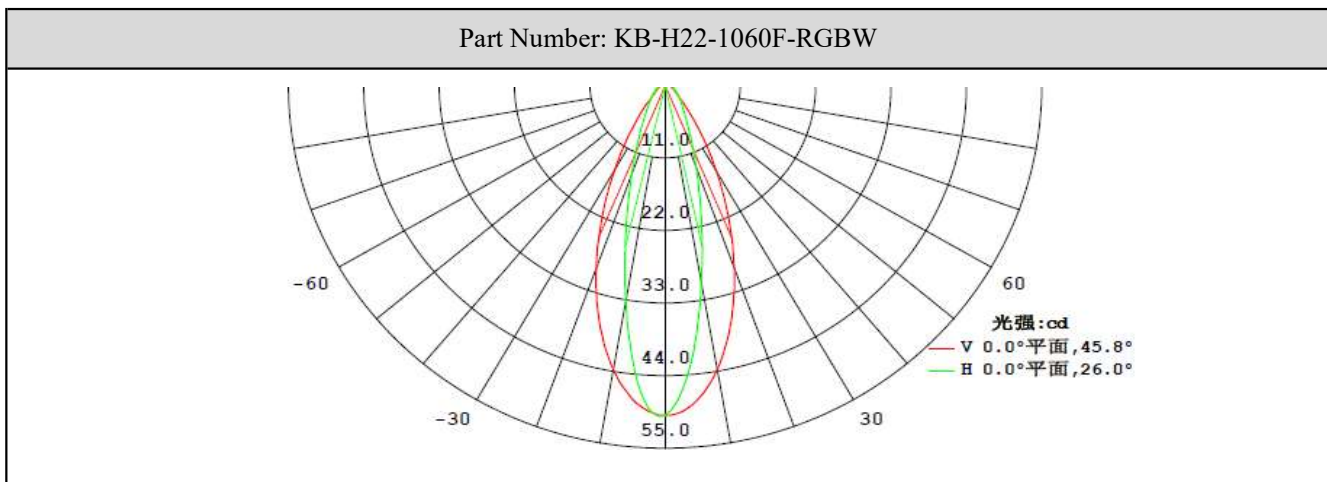
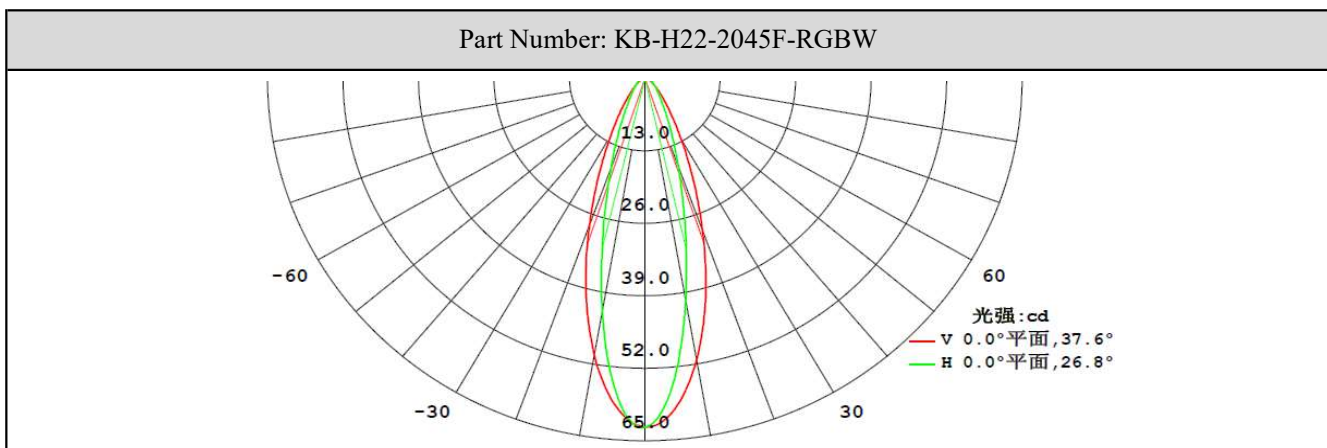
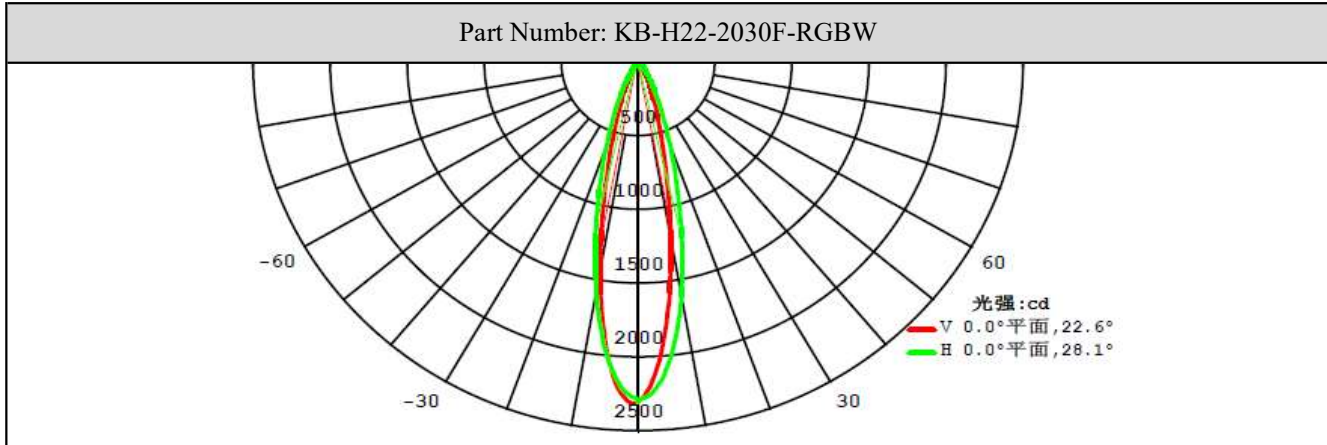

Mechanical Characteristics (产品尺寸):

(KB-H22-15PF-RGBW DRAWING)

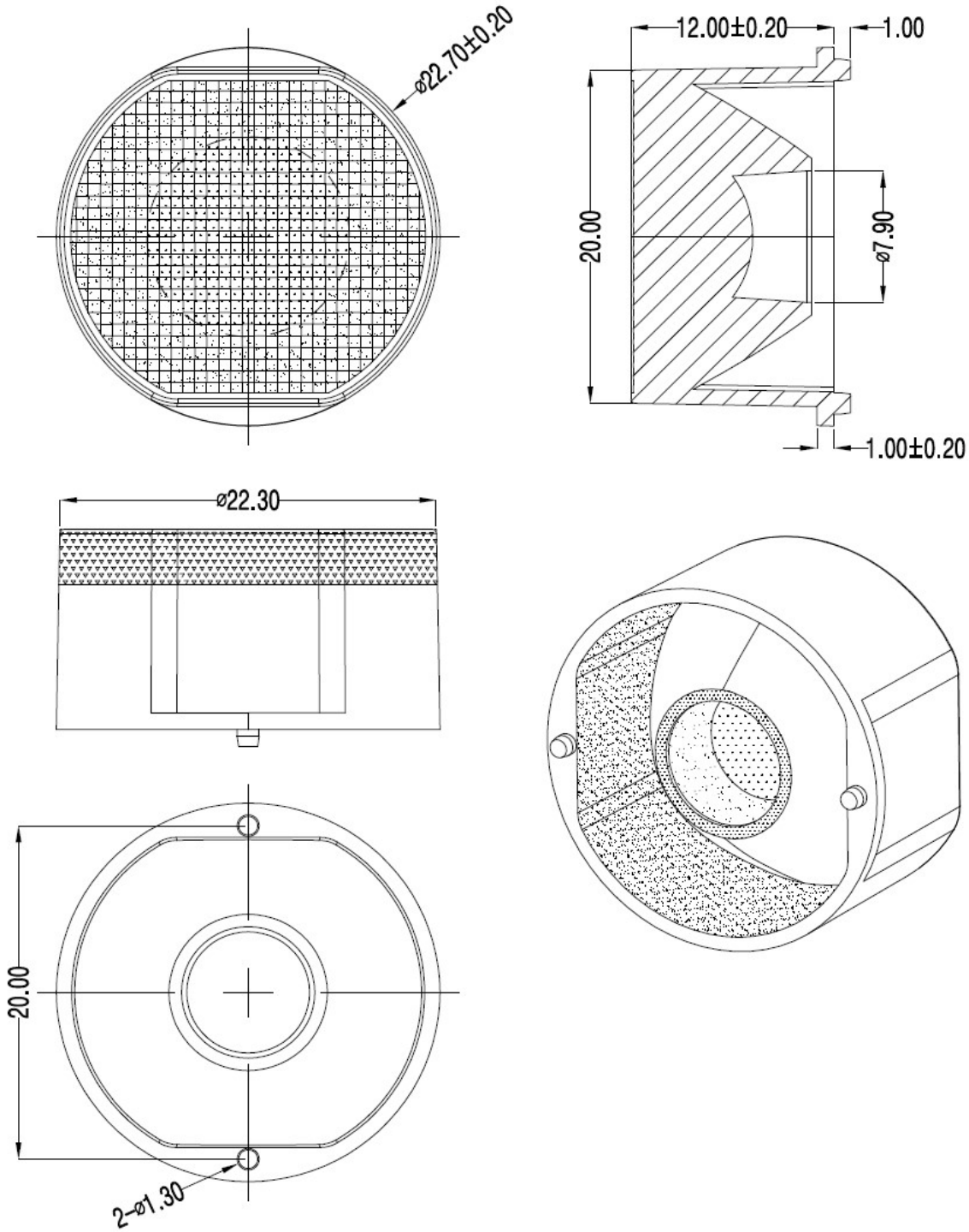

Mechanical Characteristics (产品尺寸):

