

### Product Parameters (产品描述)

产品编号 | Part Number: KB-20-xx

出光角度 | Beam Angle: 70°/80°

产品材料 | Material: Lens-PMMA/Holder-PC

工作温度 | Work Temp: <85°C

安装方式 | Fastening: Tape/Glue

支架颜色 | Holder Color: White/Black

透光率 | Transmittance: 93%

匹配LED | Match Led: Lumileds/SSC P4/Edison Led

Part Number	Lens Surface	Dimension	Beam Angle
KB-20-70	镜面/clear	Φ21.5*H10.15mm	~70°

### Direction for Use

#### (透镜 | LENS)

- 1, Please use some soft paper or pure water to clean lens ( reflector)
- 2, Don't use any industrial solvent to clean lens surface , such as alcohol
- 3, Storage environment : Temperature 0~40°C , Humidity 30%~95%
- 4, This kind of lens can make the lighting more concentrated, and it's made from transparent material , so please do not open the packages until you use them, in case of the dust and other pollutions.

**Mechanical Characteristics (产品尺寸):**

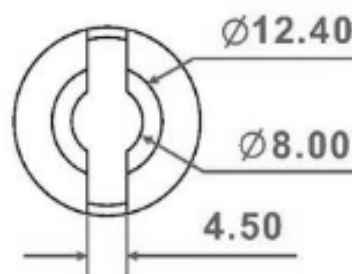
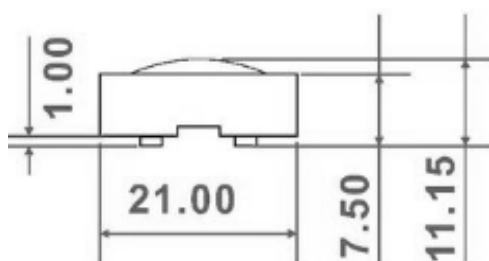
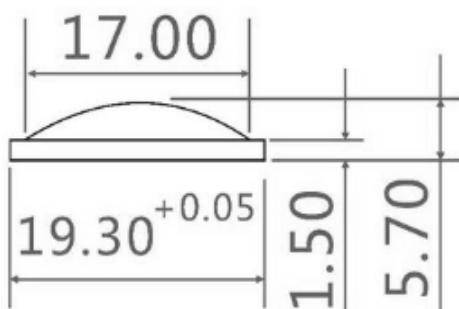

**Product Package (产品包装):**

Inner Box (内盒)

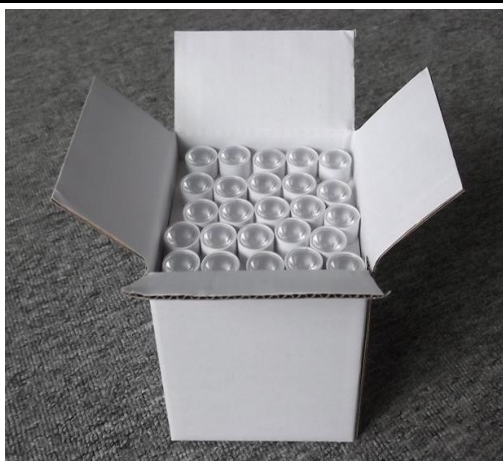

200layers/box  
Gross weight: 0.7kg/box  
Box dimension: 13\*13\*13cm

Outer Carton (外箱)



20boxes/carton  
4,000pcs/carton  
Gross weight: 14kg/CTN  
Carton Dimension: 64\*28\*32cm