

Product Parameters (产品描述)

产品编号 | Part Number: KB-20-80

出光角度 | Beam Angle: 80°

产品材料 | Material: Lens-PMMA/Holder-PC

工作温度 | Work Temp: <85°C

安装方式 | Fastening: Tape/Glue

支架颜色 | Holder Color: White/Black

透光率 | Transmittance: 93%

匹配LED | Match Led: Lumileds/SSC P4/Edison Led

Part Number	Lens Surface	Dimension	Beam Angle
KB-20-80	镜面/clear	Φ21.5*H8.7mm	~80°

Direction for Use

(透镜 | LENS)

- 1, Please use some soft paper or pure water to clean lens (reflector)
- 2, Don't use any industrial solvent to clean lens surface , such as alcohol
- 3, Storage environment : Temperature 0~40°C , Humidity 30%~95%
- 4, This kind of lens can make the lighting more concentrated, and it's made from transparent material , so please do not open the packages until you use them, in case of the dust and other pollutions.

Mechanical Characteristics (产品尺寸):

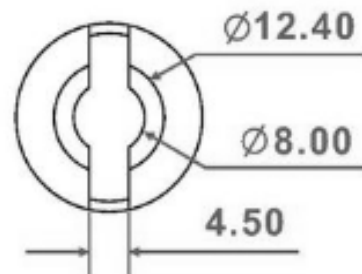
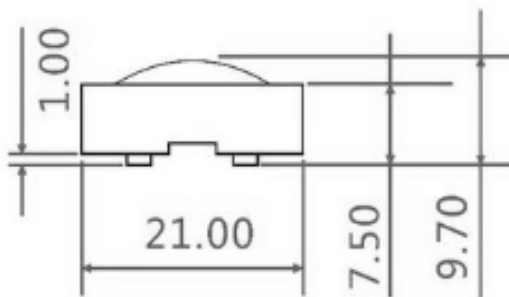
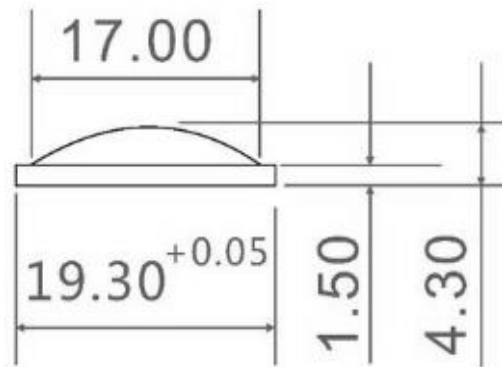

Product Package (产品包装):

Inner Box (内盒)

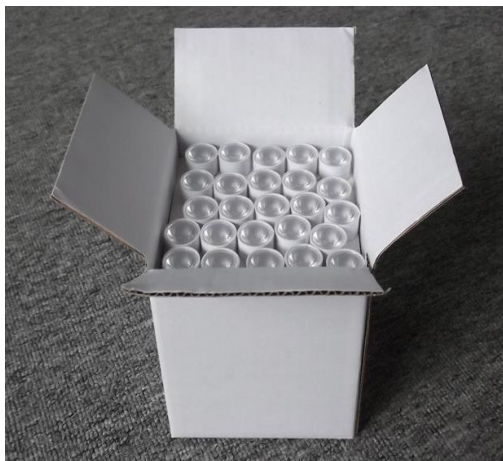

200layers/box
Gross weight: 0.7kg/box
Box dimension: 13*13*13cm

Outer Carton (外箱)



20boxes/carton
4,000pcs/carton
Gross weight: 14kg/CTN
Carton Dimension: 64*28*32cm

